

INITIALS: -
JOB NUMBER: 18362
DATE: -

MAIN FILE: -
DEPT: -
DEALER: -

PRODUCTION APPROVED

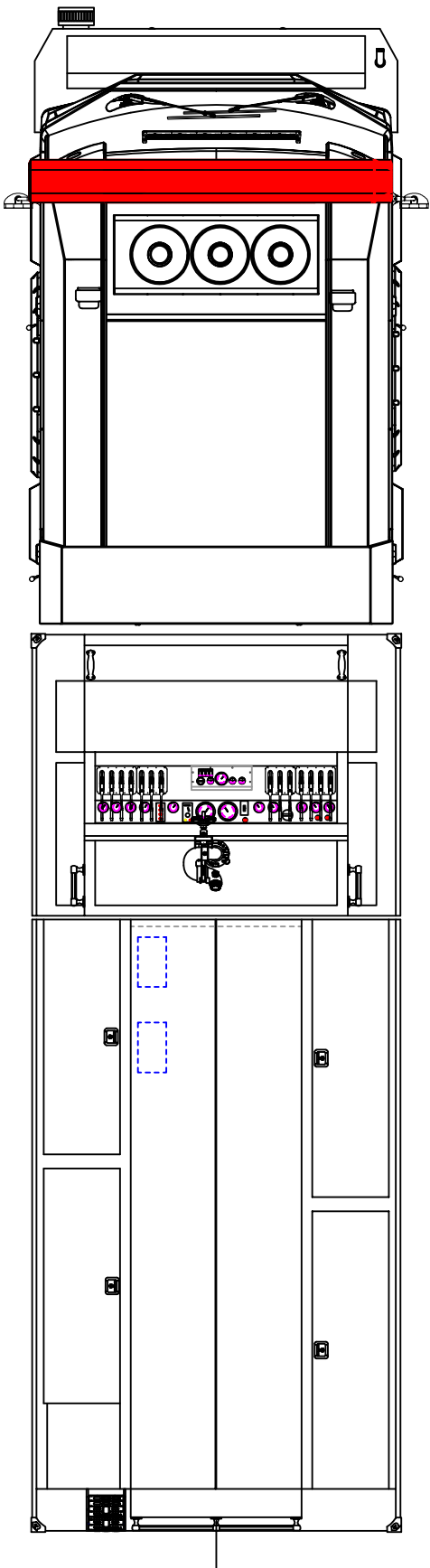

- NOTES:
- OVERALL HEIGHT IS IN LOADED CONDITION. UNLOADED HEIGHTS MAY BE 4" ABOVE HEIGHTS SHOWN.
 - DO NOT SCALE DRAWING.
 - ALL DIMENSIONS ARE APPROXIMATE AND SUBJECT TO ENGINEERING CHANGES.
 - DRAWING MAY OR MAY NOT SHOW ALL ITEMS AS DESCRIBED IN THE WRITTEN DETAIL SPECIFICATIONS.
 - INCLUSION OF AN ITEM ON THE DRAWING DOES NOT CONSTITUTE INCLUSION OF THAT ITEM WITH THE FINAL DELIVERED UNIT.
 - THE EFFECTIVE DOOR OPENINGS WILL BE APPROX. 2" LESS THAN THE NOTED COMPARTMENT OPENING FOR THE ROLL UP DOORS AND UP TO APPROX. 4" LESS FOR HINGED DOORS

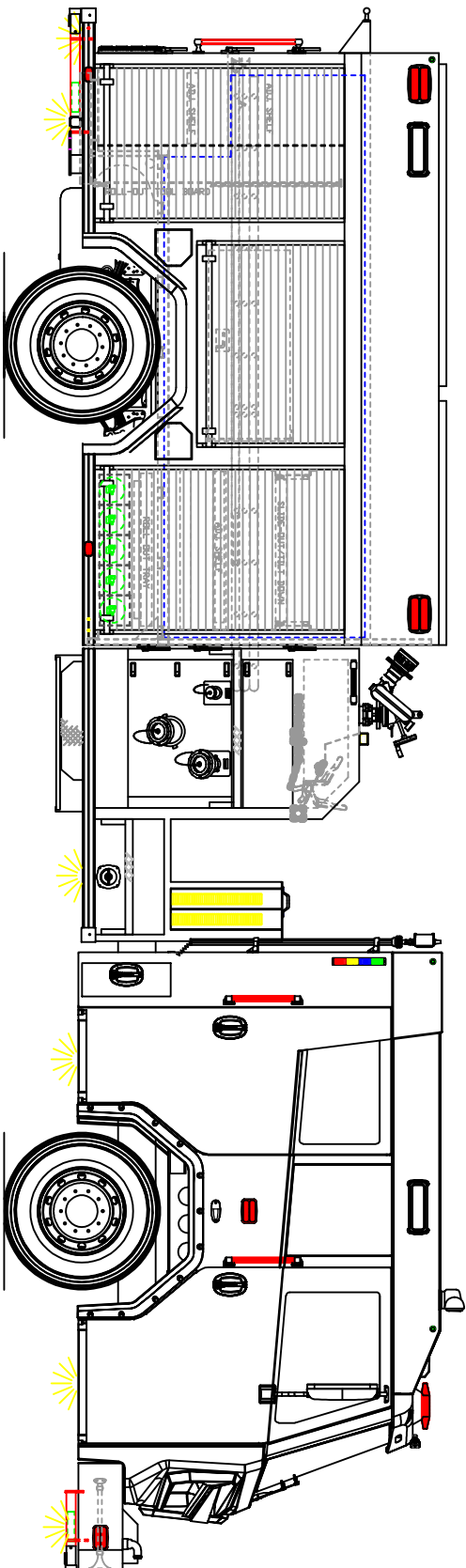
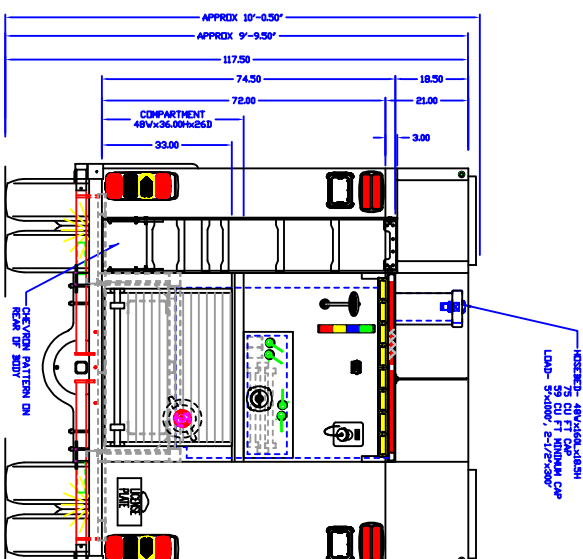
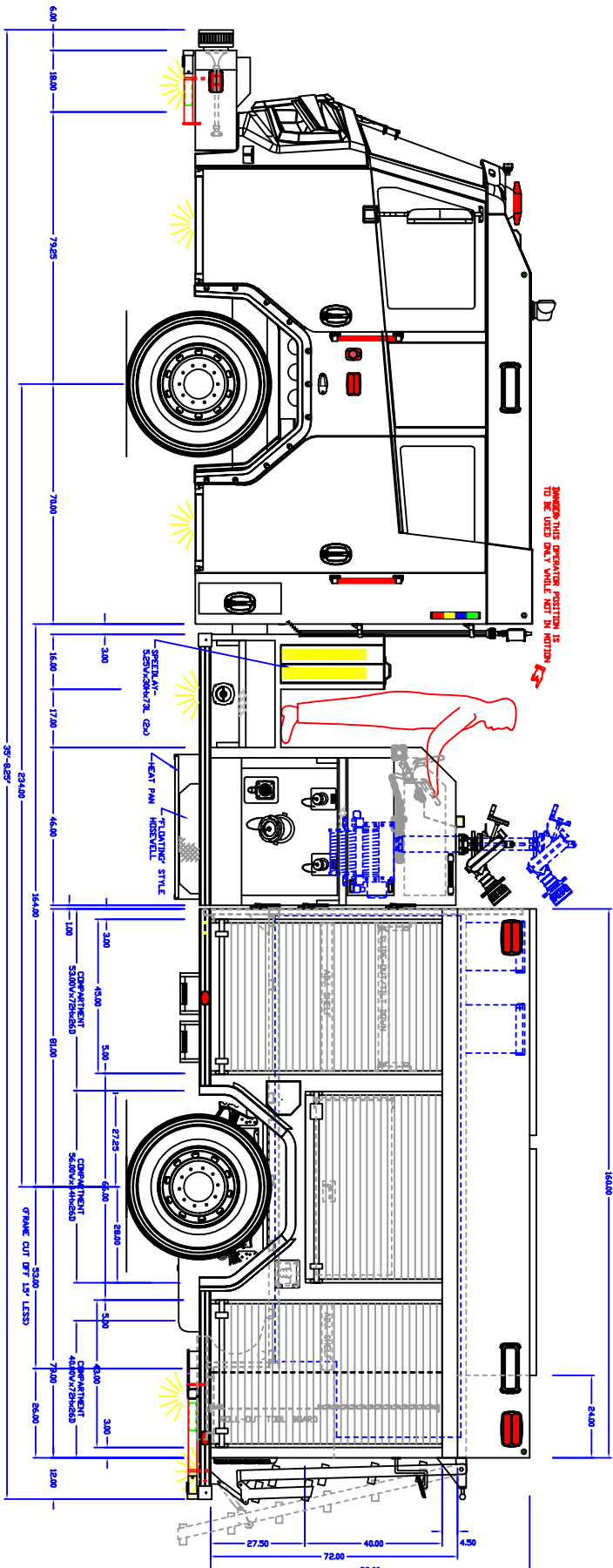
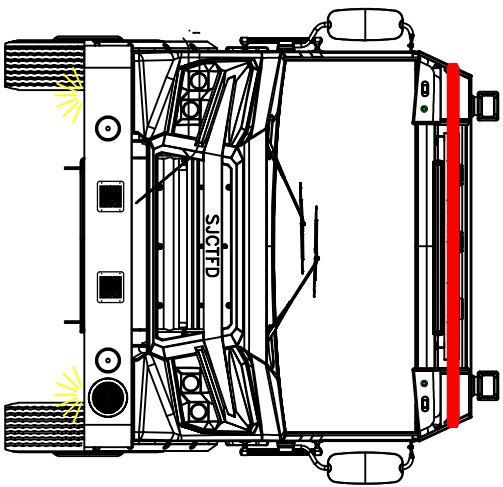

APPROVED BY:		CHASSIS: AVENGER 7011	
PUMP: HALE 1500 GPM		TANK: POLY/1000/30(FOAM)	
PANEL MATL: LINE X		COMP INTERIOR: LINE X	
MAXIMUM HEIGHT		NONE	
MAXIMUM LENGTH		NONE	
BODY WIDTH		101"	

REVISED HJ DATE 12-16-20
REVISED VLM DATE 09-24-20
REVISED VLM DATE 08-07-20
REVISED VLM DATE 03-03-19
DRAWN VLM DATE 01-03-19

PROPRIETARY AND CONFIDENTIAL
THE INFORMATION CONTAINED IN THIS DRAWING IS THE SOLE PROPERTY OF ROSENBAUER. ANY REPRODUCTION IN PART OR AS A WHOLE WITHOUT THE WRITTEN PERMISSION OF ROSENBAUER IS PROHIBITED.

ST JOSEPH
CHARTER TWP., MI



ROSENBAUER FX 3/16"
st joseph, mi